

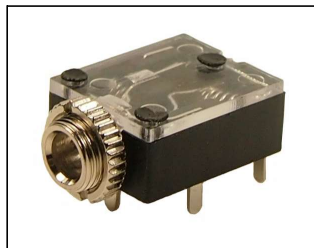

JYO-39-3P stereo unswitched 3.5mm Jack Socket.
JYO-39-5P stereo switched version.
Right angle PCB mounting.
JYO-39-3P (FC68131)
JYO-39-5P (FC68133)

SEE SEPARATE DRAWING



JYS-35 stereo switched 3.5mm Jack Socket.
Right angle PCB mounting.
Supplied with ring nut.
JYS-35 (FT6320)

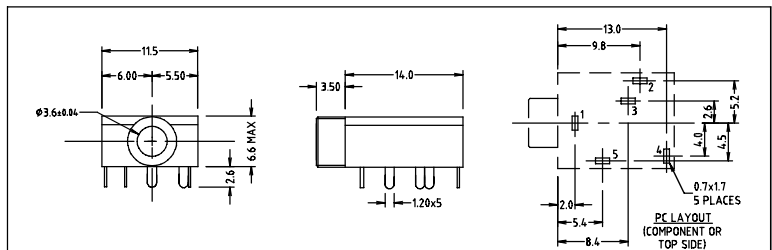

S6/BB mono switched 3.5mm Jack Socket. Panel mounting with solder tags. Also available with Special 'C' Contact to suit Far Eastern plugs.
S6/BB (CL1382)

Supplied with Nickel Plated Hex Nut.

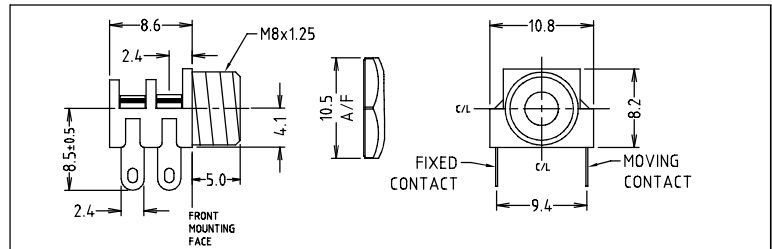

S6/BB PC mono switched 3.5mm Jack Socket. Right angle PCB mounting. Also available with Special 'C' Contact to suit Far Eastern plugs.
S6/BB PC (CL1384)

Supplied with Nickel Plated Hex Nut.

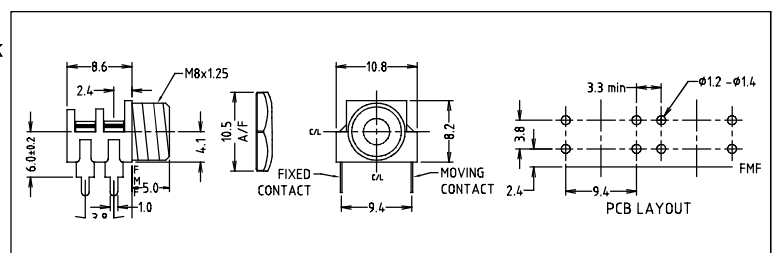

Refer to Sales Office for SMD versions.